

Scale - 1:50

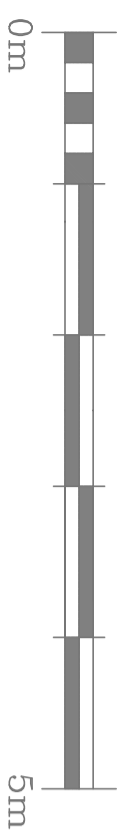

No responsibility is taken for measurements scaled off this drawing, unless otherwise stated. Use for reference purposes only.

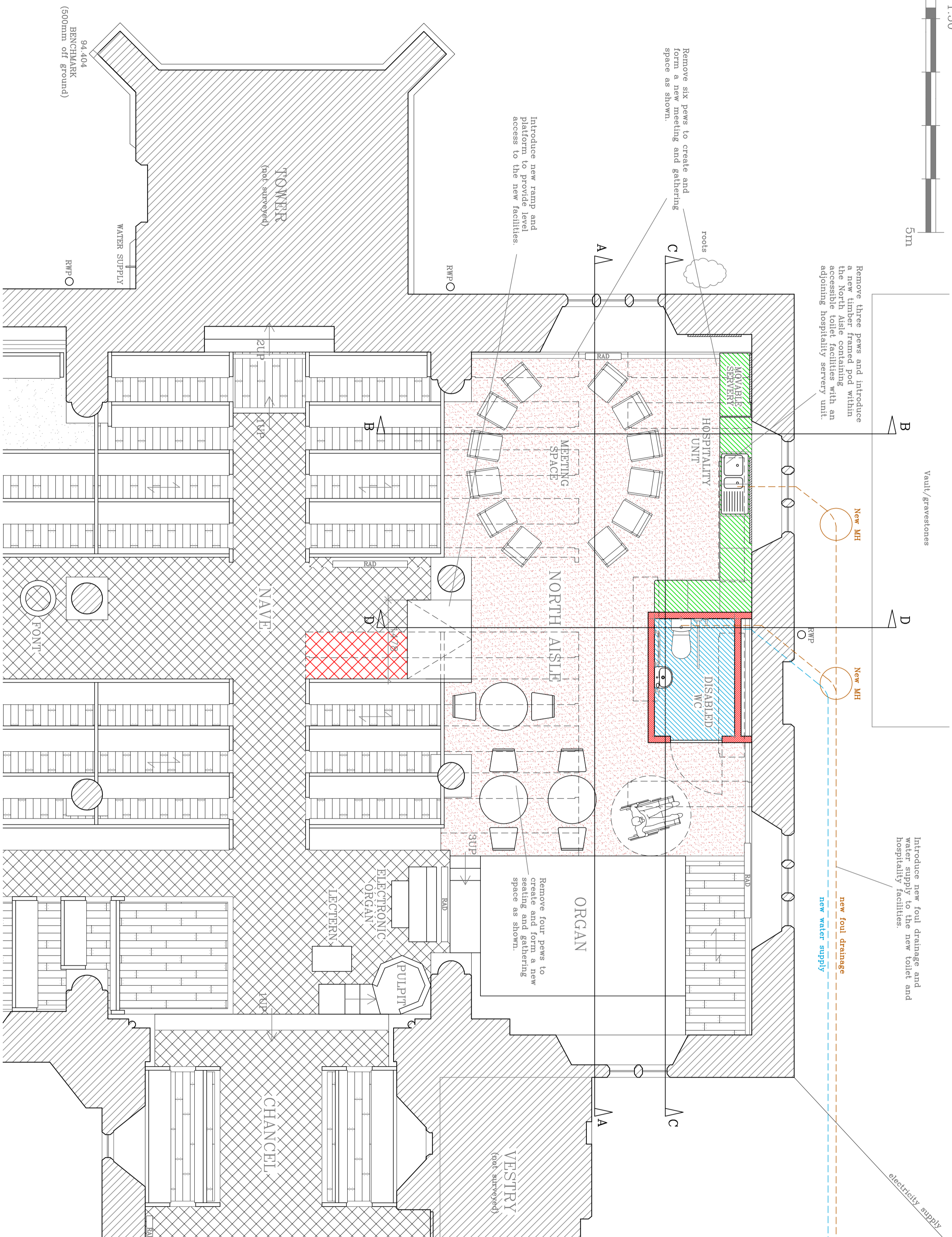

ST MICHAEL & ALL ANGELS
KINGTON ST MICHAEL

AS PROPOSED

D 05.09.18 - Alterations to layout
 C 04.09.18 - Alterations to layout
 B 08.02.18 - Alterations to layout
 A 21.08.17 - Alterations to layout

DATE AUGUST 2017

JOB ST MICHAEL, ALL ANGELS
 KINGTON ST MICHAEL

NEW FACILITIES

DRAWING FLOOR PLAN
 AS PROPOSED

SCALE 1/50 @ A2

JOB	DWG.	REV.
037	10	D

CHEDBURN DUDLEY
 BUILDING DESIGN
 CONSERVATION
 Chartered Architects
 Historic Building Consultants
 Limpley Mill, Limpley Stoke
 Bath BA2 7FJ
 T: 01225 859999 F: 01225 723990
 E: chedburn@chedburn.com